

# Case Study Demonstrating Oil Sands Results

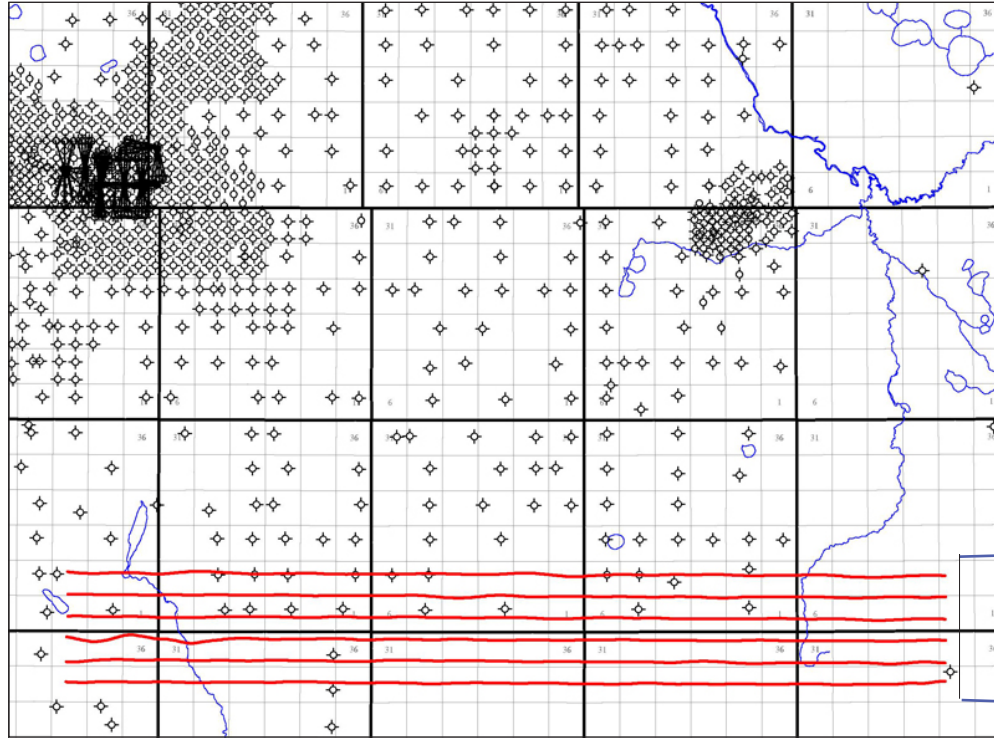

**FORT MCMURRAY, ALBERTA, CANADA**

# TYPICAL SURVEY AREA



The results of a portion of an actual survey in the Fort McMurray area are presented. This survey has a line spacing of 1 km; tighter line spacing of 500 m is recommended.

This map is typical of the Fort McMurray area.

The survey flight lines have been transferred to this base from the actual survey area.

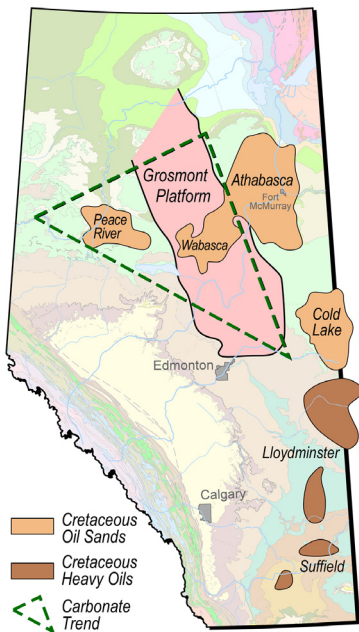

## THE OIL SANDS AND CARBONATE RESOURCE

The oil sands in Alberta and Saskatchewan, and oil in the carbonate triangle of Alberta, are a tremendous resource.

Image courtesy of the Alberta Geological Survey



This orderly, cost-effective exploration tool should be used to identify the “sweet spots” for initial project development. A strong initial project is critical to economic lease development.

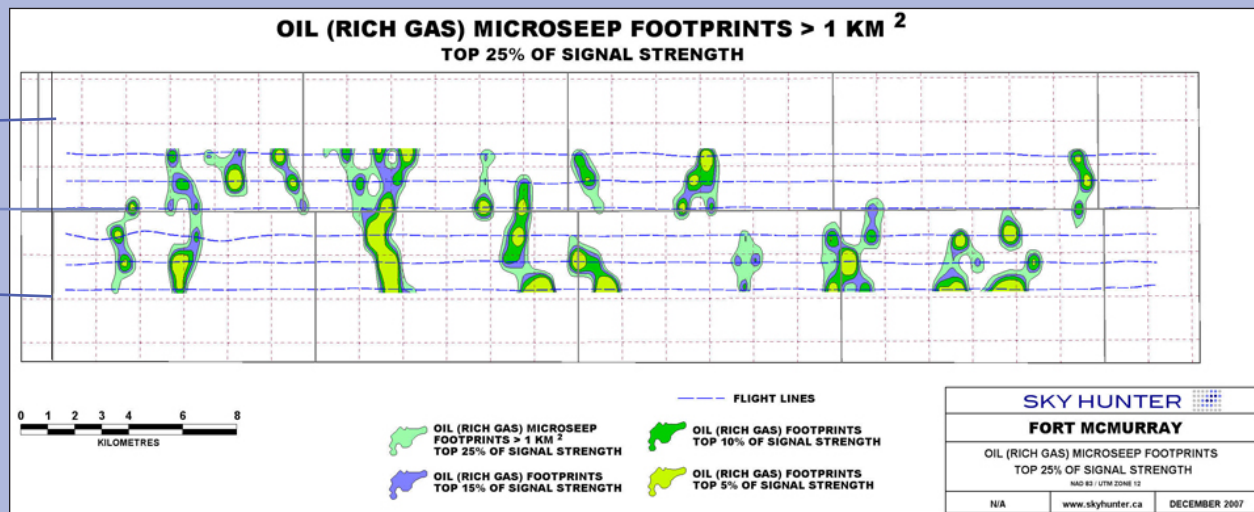

## GAS OVER BITUMEN AREAS

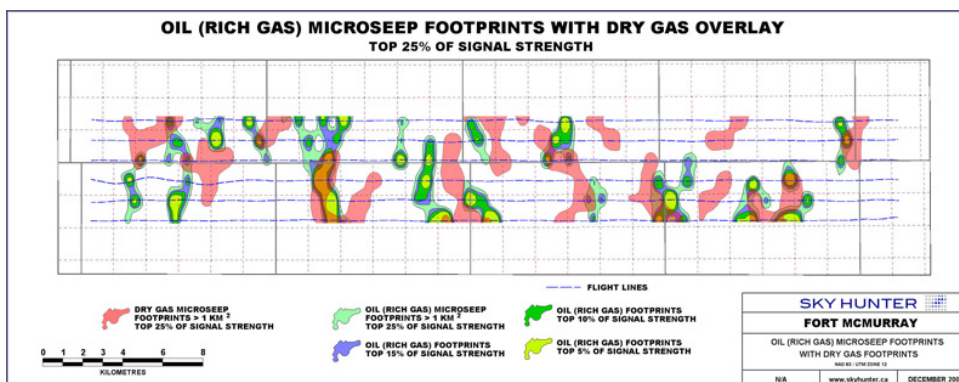

By combining the dry gas footprint results and using all geological information, gas over bitumen issues can be defined.

# SKY HUNTER

Sky Hunter Exploration is a Calgary, Canada-based company that provides a valuable exploration tool to oil and gas companies worldwide. Sky Hunter uses proprietary technology to conduct airborne surveys that map microseep data. In turn, this data predicts the presence of pressurized hydrocarbon reservoirs for further exploration, development and production by traditional methods.

**Sky Hunter Exploration Ltd.**

900, 330 – 5<sup>th</sup> Avenue SW  
Calgary, Alberta  
Canada T2P 0L4

T : 1.403.228.2175

F : 1.403.265.2419